

Pfaff 1241
Subclass

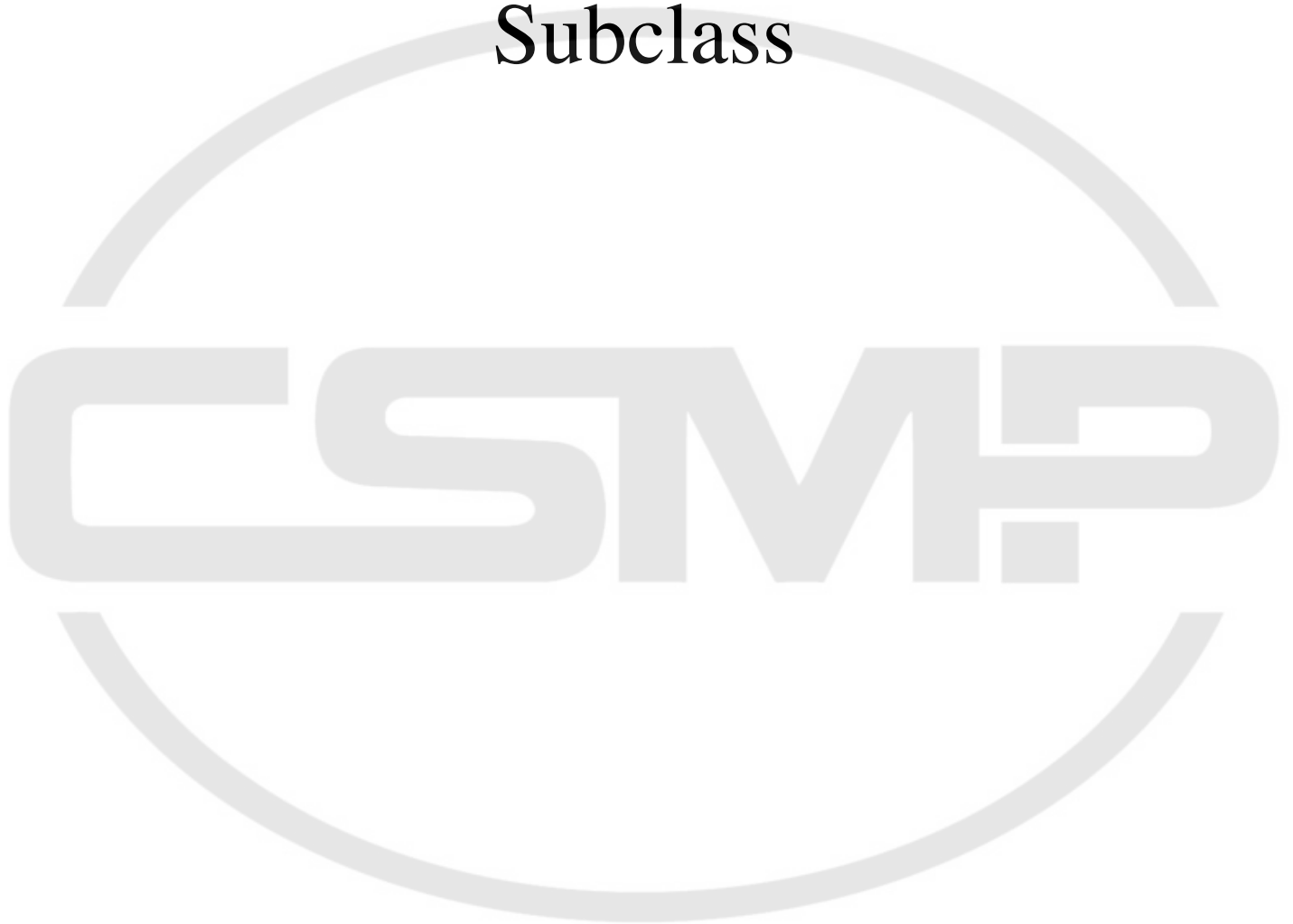

PFAFF[®] **1241**



Unterklassen-Ausstattung

Subclass parts

Composition des sous-classes

Composición de las subclases

Subclass Organization

Definición de las subclases

Unterklasse Subclass Sous-classe Subclase	Ausführung Model Version Tipo de máquina	Nadelstange Needle bar Barre à aiguille Barra de aguja	Stoffschieber Feed dog Griffe Transportador	Stichplatte Needle plate Plaque à aiguille Placa de aguja	Nähfuß Presser foot Pied presseur Pie prensateelas	Fingerschutz Finger guard Protège-débris Sakvaitebas	Zwischenstück Extension piece Pièce intermédiaire Pieza intermedia	Lineal Edge guide Guide-droit Guía recta
-2/01 [12] = 2-6 mm	BN 80 CN 80	91-009678-91	91-047996-04	91-058682-04	91-057100-03 [12/2]		91-055918-91	91-053620-91
-2/01 -900/16;/56 [12] = 2-6 mm	BN 80 B/CN 80 CN 80	91-009678-91	91-047996-04	91-058870-04	91-057100-03 [12/2]		91-055918-91	91-053620-91
-2/21 [12] = 2-6 mm	BN 80 CN 80	91-009678-91	91-047996-04	91-058682-04	91-057100-03 [12/2]		91-055918-91	
-2/21 -900/16;/56 [12] = 2-6 mm	BN 80 CN 80	91-009678-91	91-047996-04	91-058870-04	91-057100-03 [12/2]		91-055918-91	
-6/01	CN DN	91-009678-91	91-047013-04	91-048025-05	91-040349-03	91-046864-25		
-6/01 -900/16;/56	CN	91-009678-91	91-047935-04	91-058882-05	91-040349-03	91-046864-25		
-6/01	CN 8 DN 8	91-009678-91	91-047013-04	91-058494-04	91-057097-93		91-055918-91	
-6/01 -900/16;/56	CN 8	91-009678-91	91-047935-04	91-058882-05	91-057097-93		91-055918-91	
-6/01	CN 10 DN 10	91-710484-92	91-047374-04	91-048901-04	91-054559-04	91-046866-25		
-6/01 -900/16;/56	CN 10	91-710484-92	91-047370-04	91-058883-05	91-057094-03		91-055918-91	
-944/01	CN DN	91-009678-91	91-040417-04	91-041332-04	91-051255-93	91-009492-91		
-944/01 -900/16;/56	CN	91-009678-91	91-059006-04	91-058881-05	91-051255-93	91-009492-91		
-944/01	CN 8 DN 8	91-009678-91	91-040417-04	91-491675-04	91-051255-93	91-009492-91		
-944/01 -900/16;/56	CN 8	91-009678-91	91-059006-04	91-058881-05	91-051255-93	91-009492-91		

[4] = Ausführung angeben
= Indicate model
= Préciser la version
= Indiquese el tipo de máquina

[12] = Absteppbreite
= Stitching margin
= Relarge de couture
= Margen de costura

[12/2] = Absteppbreite bei Bestellung angeben
= Indicate stitching margin on order
= Indiquer le relarge de couture à la commande
= Indiquese el margen de costura en los pedidos

Unterklassen-Übersicht / Table of subclasses / Table des sous-classes / Tabla de subclasses

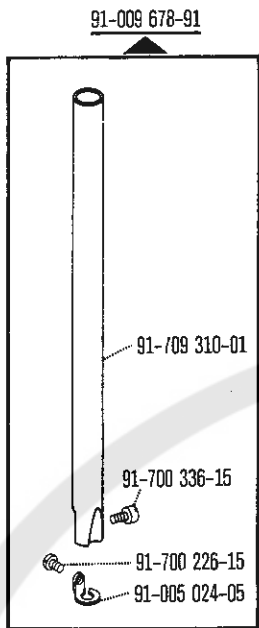

-2/01
 -2/01-900/16;/56
 -2/21
 -2/21-900/16;/56
 -6/01
 -6/01-900/16;/56
 -944/01
 -944/01-900/16;/56

-6/01
 -6/01-900/16;/56

91-040 417-04 ◻



-944/01

91-047 013-04 ◻



-6/01

91-047 370-04 ◻



-6/01-900/16;/56

91-047 374-04 ◻



-6/01

91-047 935-04 ◻



-6/01-900/16;/56

91-047 996-04 ◻



-2/01
 -2/01-900/16;/56
 -2/21
 -2/21-900/16;/56

91-059 006-04 ◻



-944/01-900/16;/56

91-041 332-04 ◻



91-048 025-05



91-048 901-04 ◻

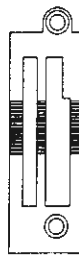

91-058 494-04 ◻



91-058 682-04



-2/01
-2/21

91-058 870-04



-2/01
-2/21

91-058 881-05

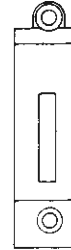

-944/01-900/16;/56

91-058 882-05



-6/01-900/16;/56

91-058 883-05



-6/01-900/16;/56

91-491 675-04



-944/01

91-040 349-03

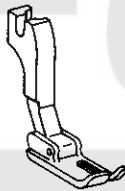

-6/01
-6/01-900/16;/56

91-051 255-93

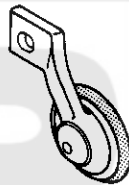

-944/01
-944/01-900/16;/56

91-054 559-04

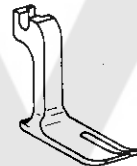

-6/01

91-057 094-03



-6/01-900/16;/56

91-057 097-03

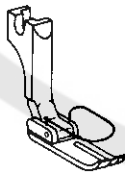

-6/01
-6/01-900/16;/56

91-057 100-03

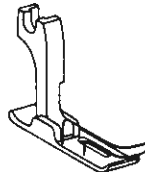

-2/01
-2/01-900/16;/56
-2/21
-2/21-900/16;/56

91-009 492-91

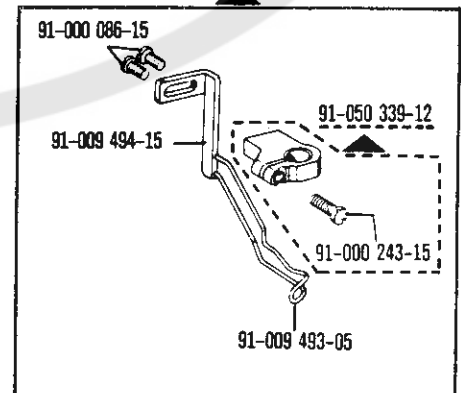

91-046 864-25

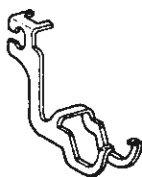

-6/01
-6/01-900/16;/56

91-046 866-25



-6/01

-944/01
-944/01-900/16;/56